

## ZB-D gear pumps for pipeline

### ZB-D gear pumps for pipeline applications:

ZB-D series **pipeline melt pump** is mainly used for stabilizing, pressurization and transportation of medium or high viscosity medium from the polymer flow layer. This series of **gear melt pump** adopts conduction oil heating, and applies to PET, PBT, PA, PC, PS, SAN, ABS, HIPS, PP, PE, POM, etc.



### Technical parameter of gear pump for pipeline:

- ◆ Material for [Melt Pump](#) Body: High temperature tool steel, chromenickel steel or stainless steel
- ◆ Material for Gear: M2 Steel (Optional), stainless steel
- ◆ Material for Sliding Bearing: High Temperature Tool Steel or Stainless Steel
- ◆ Gear Tooth Type: straight gear, helical gear, herringbone gear
- ◆ Shaft Sealing: Spiral sealing, packing sealing, spiral and packing sealing or other combined sealing
- ◆ Heating System: Heating Medium or Conduction Oil Heating
- ◆ Model/Volume Range: 0.5CC - 12000CC, 0.5cm<sup>3</sup>/rev - 12000cm<sup>3</sup>/rev

### Features of [gear pumps](#) for pipeline:

- ◆ Stable output pressure
- ◆ Improve the quality of products
- ◆ Improve the productivity of extrusion
- ◆ Reduce unit energy consumption
- ◆ Extend the service life of the whole machine

### Operating Parameter of Pipeline melt pump:

- ◆ Inlet Pressure: ≤12MPa
- ◆ Viscosity: ≤40000 Pa.s
- ◆ Working Temperature: ≤400°C (750°F)
- ◆ Cleaning Temperature: ≤450°C (850°F)
- ◆ Outlet Pressure: 40MPa(6000psi)
- ◆ Differential Pressure: ≤25MPa





# Batte Melt Pump Zhengzhou Co., Ltd

E-mail: [sales@battemachinery.com](mailto:sales@battemachinery.com)

Address: No.11 Changchun Road, High-tech Zone, Zhengzhou, China

Type	CC/Rev	Capacity (L/H)	Heating power (kw)	Driven system (km)	Pressure	Temperature
ZB-0.2	0.2	0.2-0.6	0.5	0.37	Inlet pressure: $\geq 0\text{Mpa}$  Exit pressure: $\leq 35\text{Mpa}$	Operating temperature: $\leq 350^{\circ}\text{C}$  Clearing temperature: $\leq 450^{\circ}\text{C}$
ZB-1	1	1-3	1	0.5		
ZB-2	2	2-6	1	0.75		
ZB-5	5	5-15	1	1.1		
ZB-10	10	10-30	1	1.5		
ZB-20	20	20-60	2	2.2		
ZB-31.5	31.5	30-90	2	3		
ZB-50	50	50-150	2	4		
ZB-100	100	100-300	3	5.5		
ZB-150	150	150-450	4	7.5		
ZB-200	200	200-600	4	11		
ZB-250	250	250-750	5	15		
ZB-315	315	300-900	6	18.5		
ZB-400	400	400-1200	8	22		
ZB-500	500	500-1500	10	30		
ZB-630	630	600-1800	12	37		
ZB-800	800	800-2400	15	45		
ZB-1000	1000	1000-3000	18	55		
ZB-1500	1500	1200-4500	20	75		

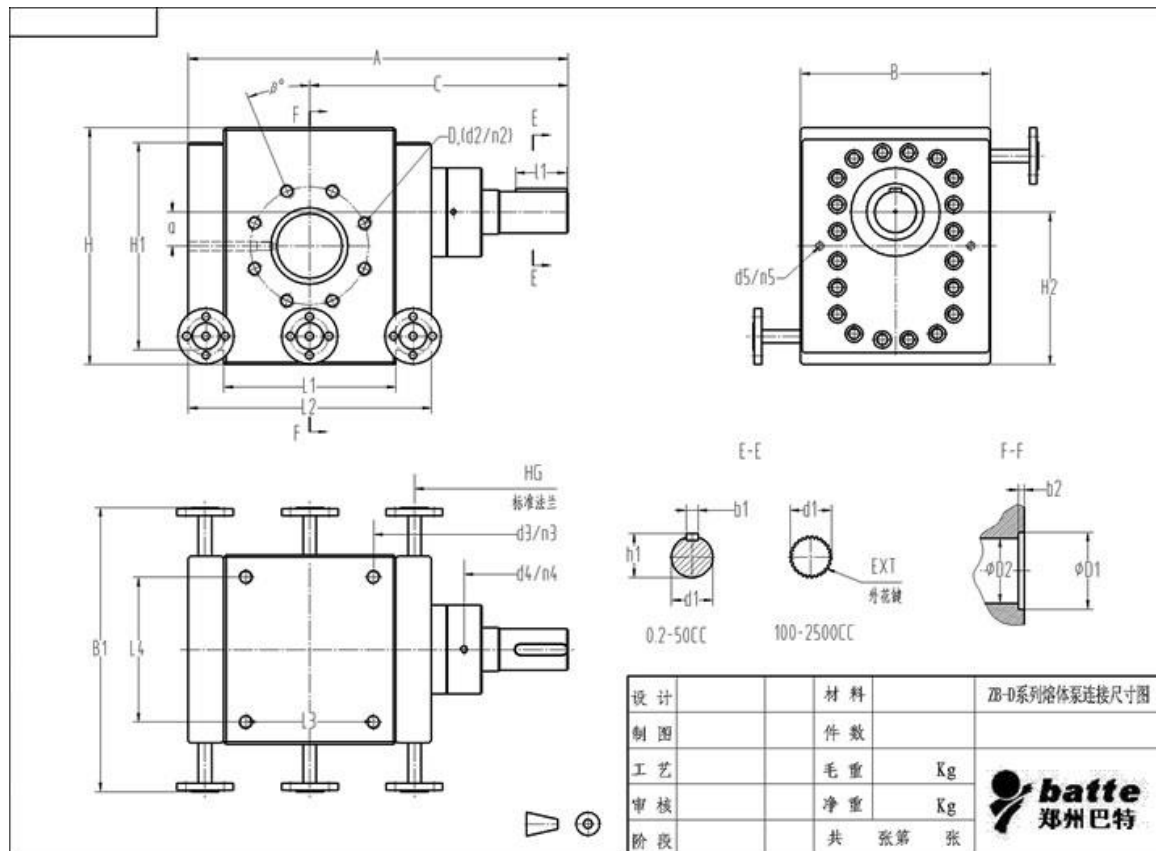

<http://www.melt pump.com/>  
[sales@battemachinery.com](mailto:sales@battemachinery.com)



## Batte Main Products

### Melt Pump Series:

- ★ [ZB-B standard extrusion melt pump](#)
- ★ [ZB-C reinforced melt pump for extrusion](#)
- ★ [ZB-D gear pumps for pipeline](#)
- ★ [ZB-E pressurized melt pump](#)
- ★ [ZB-F melt pump for reactor](#)
- ★ [ZB-H high pressure extruder pump](#)
- ★ [ZB-K polymer discharge gear pump](#)
- ★ [ZB-R extrusion rubber pump](#)

- ★ [RS double shaft rubber gear pump](#)
- ★ [ZB-U spinning pump](#)
- ★ [ZB-W chemical metering melt pump](#)
- ★ [ZB-X gear metering chemical pump](#)
- ★ [New type melt pump](#)
- ★ [Melt pump spare parts](#)
- ★ [PID control system for extruder](#)
- ★ [PLC control system for extrusion line](#)
- ★ [PDF download](#)

### Screen Changer Series:

- ★ [Manual screen changer](#)
- ★ [Slide plate screen changer](#)
- ★ [Continuous piston screen changer](#)
- ★ [Continuous backflush screen changer](#)
- ★ [Automatic belt screen changer](#)
- ★ [Pelletizer filter without wire mesh](#)
- ★ [Screen changer spare parts](#)
- ★ [PDF download](#)

### Loss in Weight Feeder Series:

(For granule, sheet, powder, liquid, etc.)

- ★ [Loss in weight screw feeder](#)
- ★ [Volumetric screw feeder](#)
- ★ [Liquid polymer feed system](#)
- ★ [Multi-component gravimetric feeders](#)
- ★ [Gravimetric feeder control system](#)
- ★ [Feeding system](#)
- ★ [PDF download](#)